



Before

After

# Half Sepia Tone

This effect works on all photos but is best with high saturation photos.

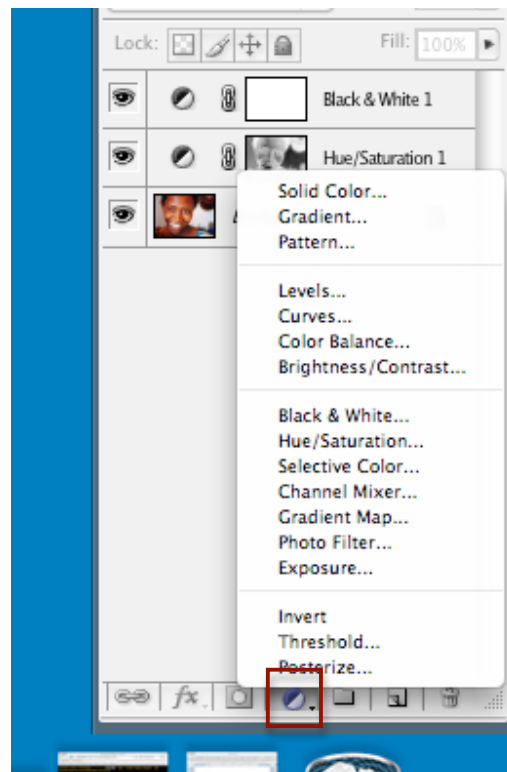

1. Open new photo in Photoshop.
2. In the Layers Palette click the  and choose "Hue/Saturation" (as seen below)

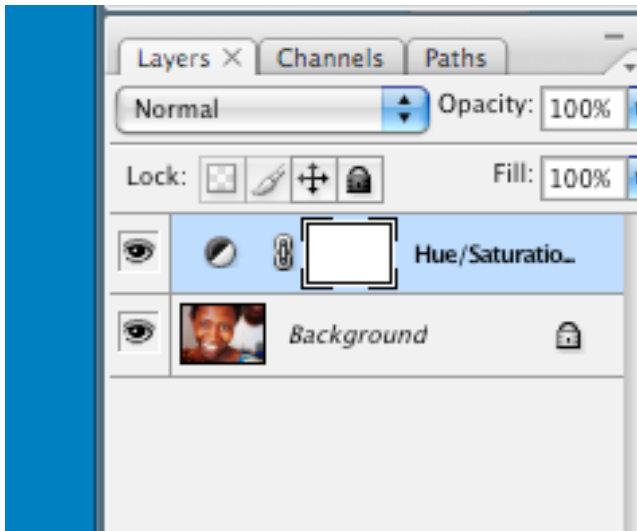

3. The Hue/Saturation window will pop up. Check "Colorize" then change Hue to 25, and Saturation to 50. Click OK

4. Your image will look like a bright sepia tone
5. Now make sure the mask for Hue/Saturation (the white box) is clicked as seen Below.



6. Go to the top toolbar and click Image> Apply Image and use the default settings. The only one you may want to change is the "Invert Setting" but it's up to you! Click Ok.
7. Add a black and white adjustments layer by clicking the  in the layers palette. Choose "Black and White" and click ok.
8. In the Layers Palette click *fx*, go to blending options, and click the "Soft Light" blending mode.
9. Double click on the black and white adjustment layer (The  next to Black and White in the Layers Palette).
10. The Black and White color adjustment will come up. You can adjust each color to your liking. The Red and Yellow make the most difference.
11. You're done!